

BEAM EXPANDER

# BE-5x-1064-K

en | Data sheet | 1.1.1

- Fused silica beam expanders, 1064 nm
- Fixed magnification factor 5x
- Maximum input beam 2.5 mm
- Variably adjustable divergence
- Very compact design



Wavelength	1064 nm	Housing length	45.7 mm
Magnification	5x	Housing diameter	44 mm
Max. input beam diameter	2.5 mm	Transmission (>)	96%
Max. output aperture	20 mm	Cooling method	Air
Optical principle	Galilei <sup>[1]</sup>	Lens material	Fused silica
Adjustable divergence	Yes	Mounting thread	M30x1 / M43x0.5
Adjustable magnification	No		

<sup>[1]</sup> No internal focus



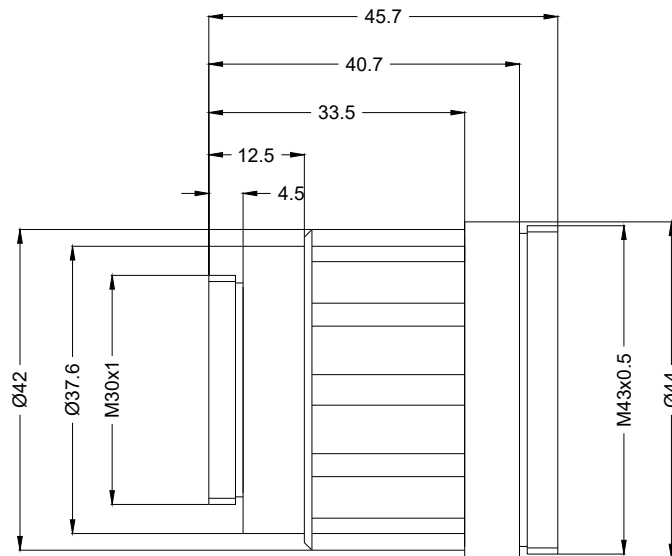

Beam expander

BE-5x-1064-K

Dimensions are given in millimeters and are intended as reference values.  
Binding information is available on request.

