

BEAM EXPANDER

BE-2x-10.6-F

en | Data sheet | 1.2

- ZnSe Beam Expander, 10600 nm
- Fixed magnification factor 2x
- Maximum input beam 8 mm
- Variably adjustable divergence



Wavelength	10600 nm	Housing length	52.2 mm
Magnification	2x	Housing diameter	46 mm
Max. input beam diameter	8 mm	Transmission (>)	96%
Max. output aperture	19 mm	Cooling method	Air
Optical principle	Galilei ^[1]	Lens material	ZnSe
Adjustable divergence	Yes	Mounting thread	M30x1 / M43x0.5
Adjustable magnification	No		

^[1] No internal focus



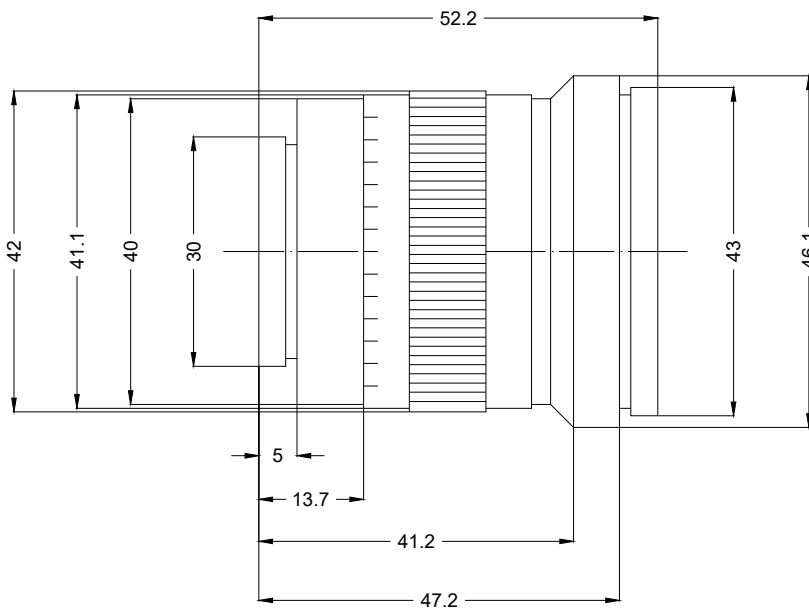

Beam expander

BE-2x-10.6-F

Dimensions are given in millimeters and are intended as reference values.
Binding information is available on request.

