

BEAM EXPANDER

# BE-1.1x-1064-F

en | Data sheet | 1.2

- Fused silica beam expanders, 1064 nm
- Fixed magnification factor 1.1x
- Maximum input beam 12 mm
- Variably adjustable divergence



Wavelength	1064 nm	Housing length	75.5 mm
Magnification	1.1x	Housing diameter	42 mm
Max. input beam diameter	12 mm	Transmission (>)	96%
Max. output aperture	16 mm	Cooling method	Air
Optical principle	Galilei <sup>[1]</sup>	Lens material	Fused silica
Adjustable divergence	Yes	Mounting thread	M30x1
Adjustable magnification	No		

<sup>[1]</sup> No internal focus



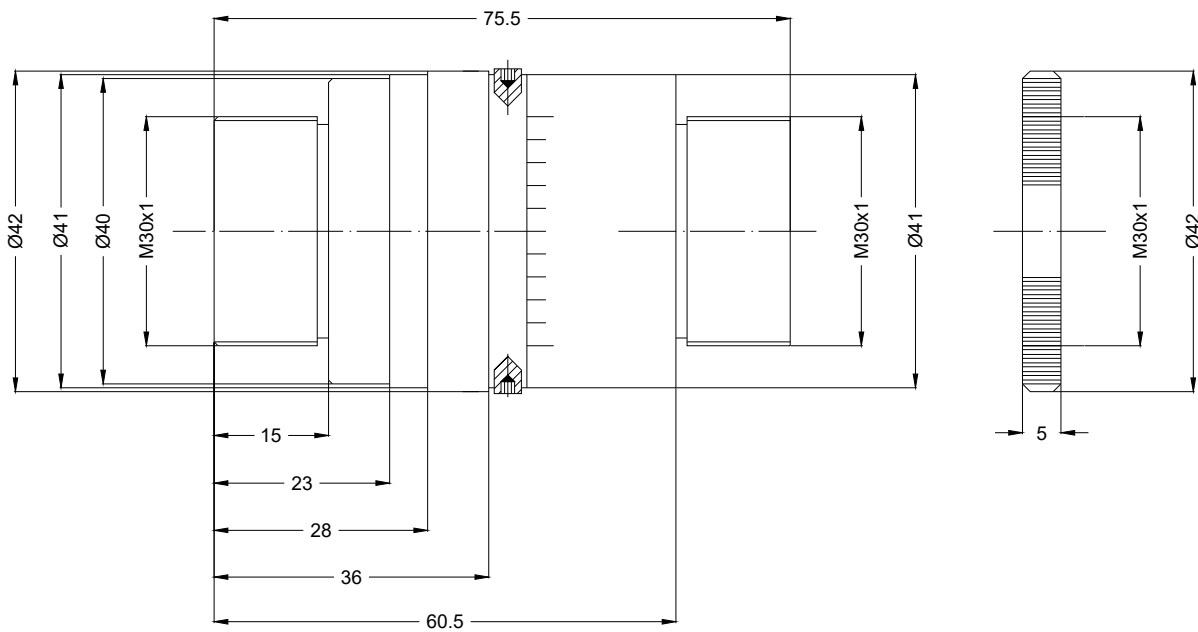

Beam expander

BE-1.1x-1064-F

Dimensions are given in millimeters and are intended as reference values.  
Binding information is available on request.

