

BEAM EXPANDER

BE-1.5x-355-F-8

en | Data sheet | 1.2

- Fused silica beam expanders, 355 nm
- Fixed magnification factor 1.5x
- Maximum input beam 8 mm
- Variably adjustable divergence



Wavelength	355 nm	Housing length	75.5 mm
Magnification	1.5x	Housing diameter	42 mm
Max. input beam diameter	8 mm	Transmission (>)	96%
Max. output aperture	16 mm	Cooling method	Air
Optical principle	Galilei ^[1]	Lens material	Fused silica
Adjustable divergence	Yes	Mounting thread	M30x1
Adjustable magnification	No		

^[1] No internal focus



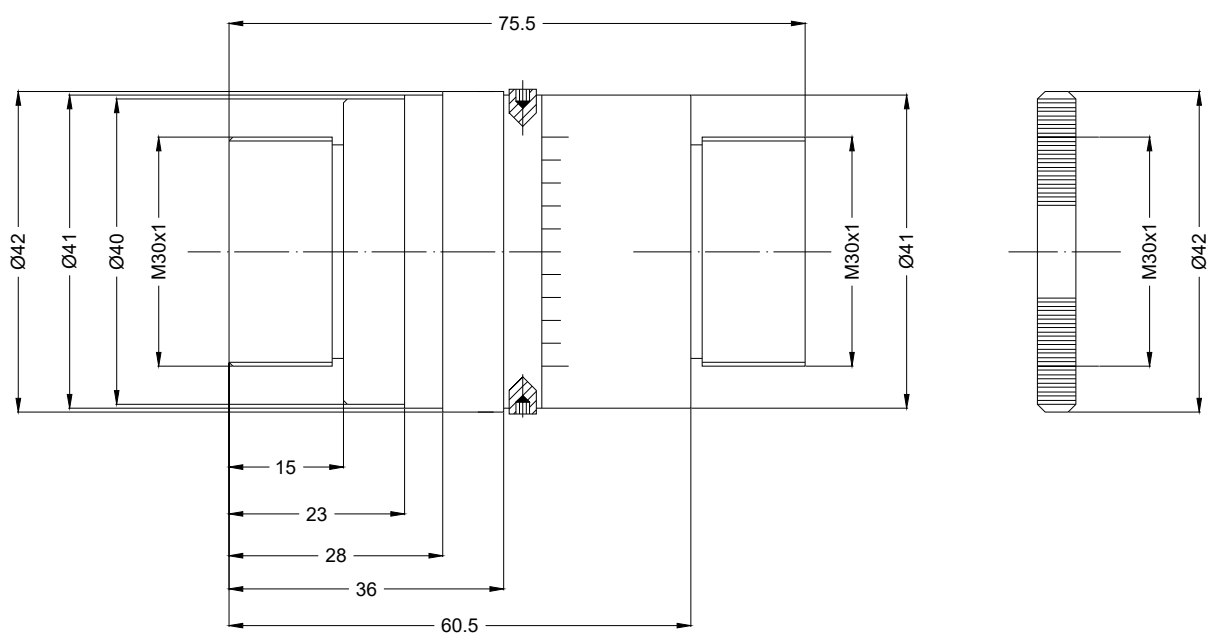

Beam expander

BE-1.5x-355-F-8

Dimensions are given in millimeters and are intended as reference values.
Binding information is available on request.

