

F - T H E T A L E N S

f-120T-10-1030-1080

en | Data sheet | 1.1

- Telecentric fused silica lens
- Wavelength 1030 – 1080 nm
- Nominal focal length 120 mm
- Max. input beam diameter 10 mm
- Maximum working area 50 x 50 mm



Wavelength	1030 – 1080 nm	Mirror distance m1/m2	12.5 / 24 mm
Nominal focal length	120 mm	Cooling method	Air
Effective focal length	120.000 mm	Lens material	Fused silica
Flange focal length	206.290 mm	Anti-reflective coating	Standard
Max. input beam diameter	10 mm	Telecentric error	3 °
Working distance	168.590 mm	Mounting thread	M85x1
Max. scan field	50 x 50 mm	Lens diameter	120 mm
Minimum spot size	23.37 µm		

Information is subject to change without notice.
Product photos are non-binding and may show customized features.



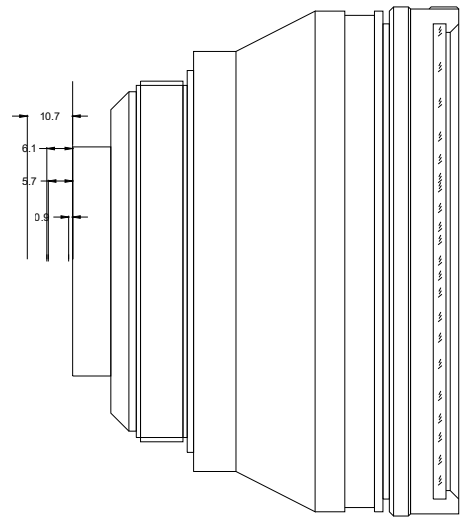
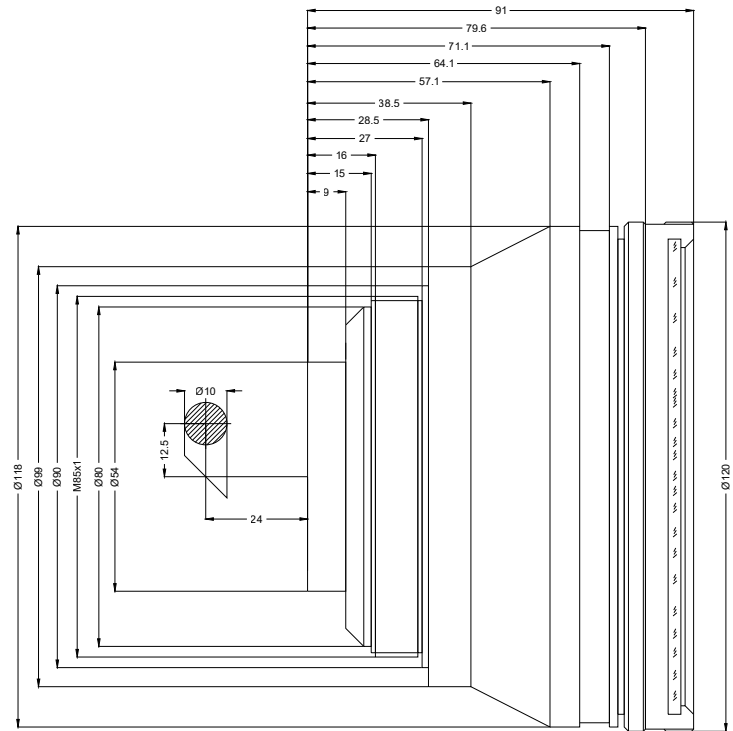

F-Theta lens

f-120T-10-1030-1080

Dimensions are given in millimeters and are intended as reference values.
Binding information is available on request.

