

F - T H E T A L E N S

f-150T-20-10.6

en | Data sheet | 1.0

- Telecentric F-Theta Lens, 10600 nm, ZnSe
- Nominal focal length 150 mm
- Max. input beam diameter 20 mm
- Maximum working area 90 x 90 mm
- Fine focus, high power density



Wavelength	10600 nm	Mirror distance m1/m2	25.6 / 18.6 mm
Nominal focal length	150 mm	Anti-reflective coating	Standard
Effective focal length	150.000 mm	Telecentric error	6.4 °
Flange focal length	254.190 mm	Cooling method	Air
Max. input beam diameter	20 mm	Lens material	ZnSe
Working distance	170.960 mm	Mounting thread	M85x1
Max. scan field	90 x 90 mm	Lens diameter	154 mm
Minimum spot size	72.3 µm		

Information is subject to change without notice.
Product photos are non-binding and may show customized features.



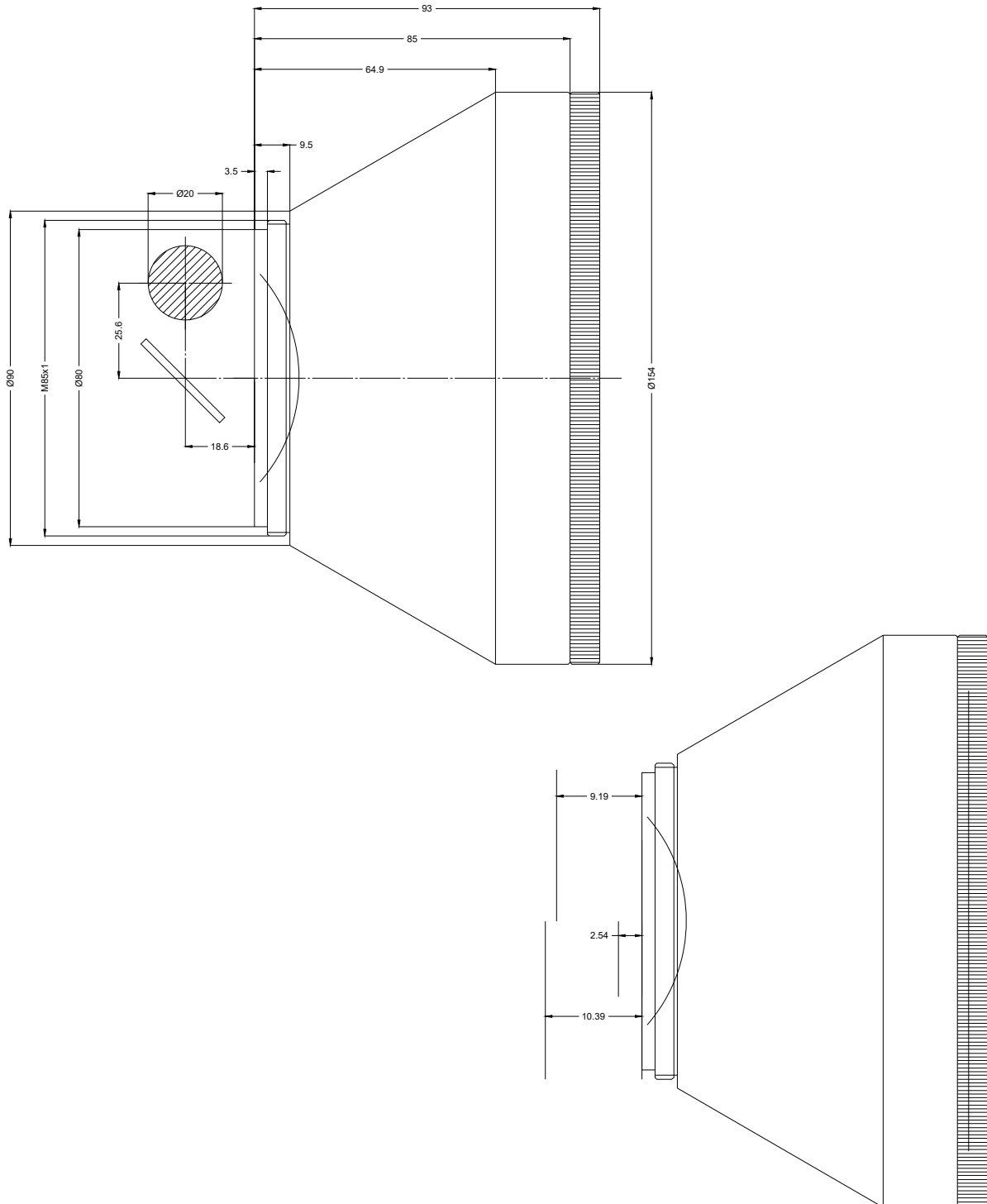

F-Theta lens

f-150T-20-10.6

Dimensions are given in millimeters and are intended as reference values.
Binding information is available on request.

