

F - T H E T A L E N S

f-200T-15-355

en | Data sheet | 1.1

- Telecentric fused silica lens, 355 nm
- Nominal focal length 200 mm
- Max. input beam diameter 15 mm
- Maximum working area 120 x 120 mm
- Fine focus, high power density



Wavelength	355 nm	Mirror distance m1/m2	18.41 / 23.4 mm
Nominal focal length	200 mm	Anti-reflective coating	Standard
Effective focal length	200.000 mm	Telecentric error	2.8 °
Flange focal length	434.671 mm	Cooling method	Air
Max. input beam diameter	15 mm	Lens material	Fused silica
Working distance	286.171 mm	Mounting thread	M85x1
Max. scan field	120 x 120 mm	Lens diameter	200 mm
Minimum spot size	8.66 µm		

Information is subject to change without notice.
Product photos are non-binding and may show customized features.



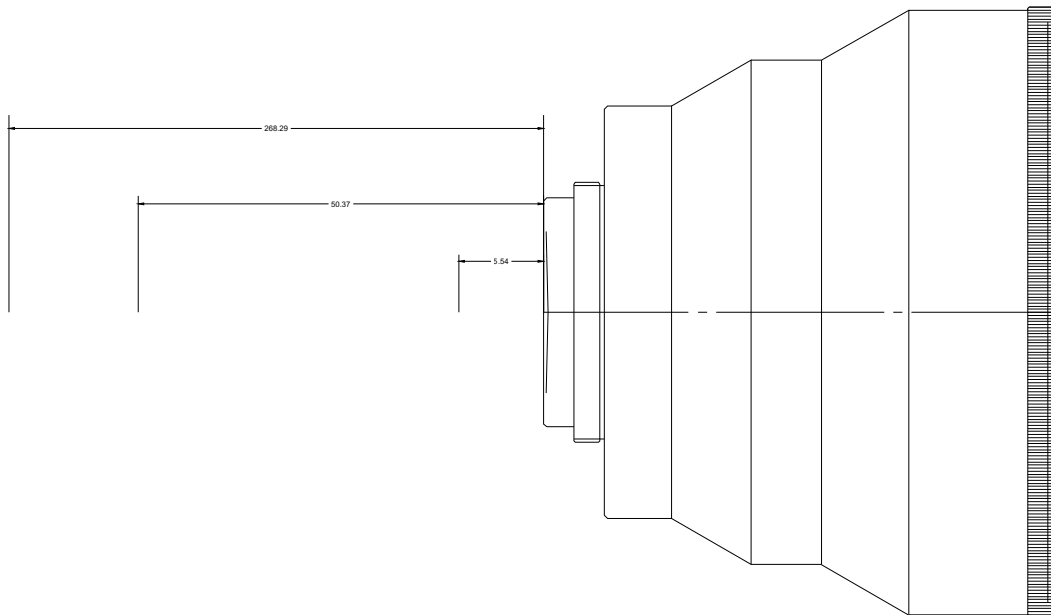
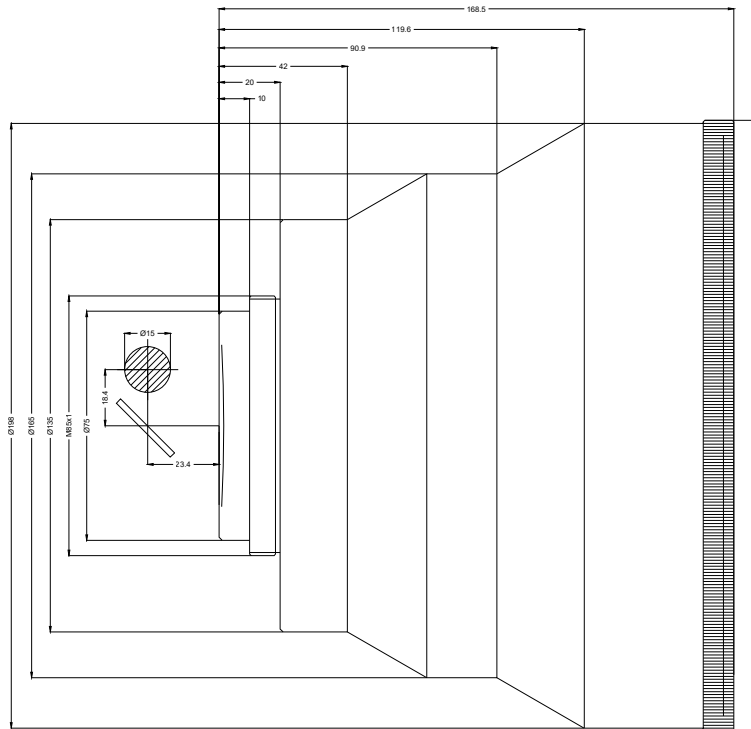

F-Theta lens

f-200T-15-355

Dimensions are given in millimeters and are intended as reference values.
Binding information is available on request.

