

F - T H E T A L E N S

f-120T-10-510-550

en | Data sheet | 1.0

- Telecentric fused silica lens
- Wavelength 510 – 550 nm
- Nominal focal length 120 mm
- Max. input beam diameter 10 mm
- Maximum working area 65 x 65 mm



Wavelength	510 – 550 nm	Mirror distance m1/m2	13 / 21.5 mm
Nominal focal length	120 mm	Anti-reflective coating	Standard
Effective focal length	121.686 mm	Telecentric error	20 °
Flange focal length	245.324 mm	Cooling method	Air
Max. input beam diameter	10 mm	Lens material	Fused silica
Working distance	166.741 mm	Mounting thread	M85x1
Max. scan field	65 x 65 mm	Lens diameter	10 mm
Minimum spot size	10.44 μm		

Information is subject to change without notice.
Product photos are non-binding and may show customized features.



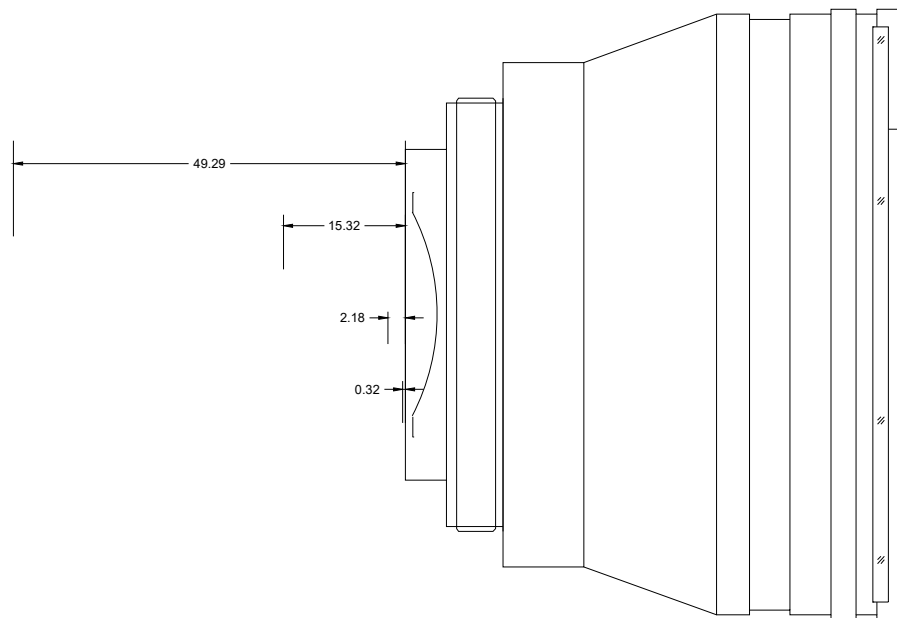
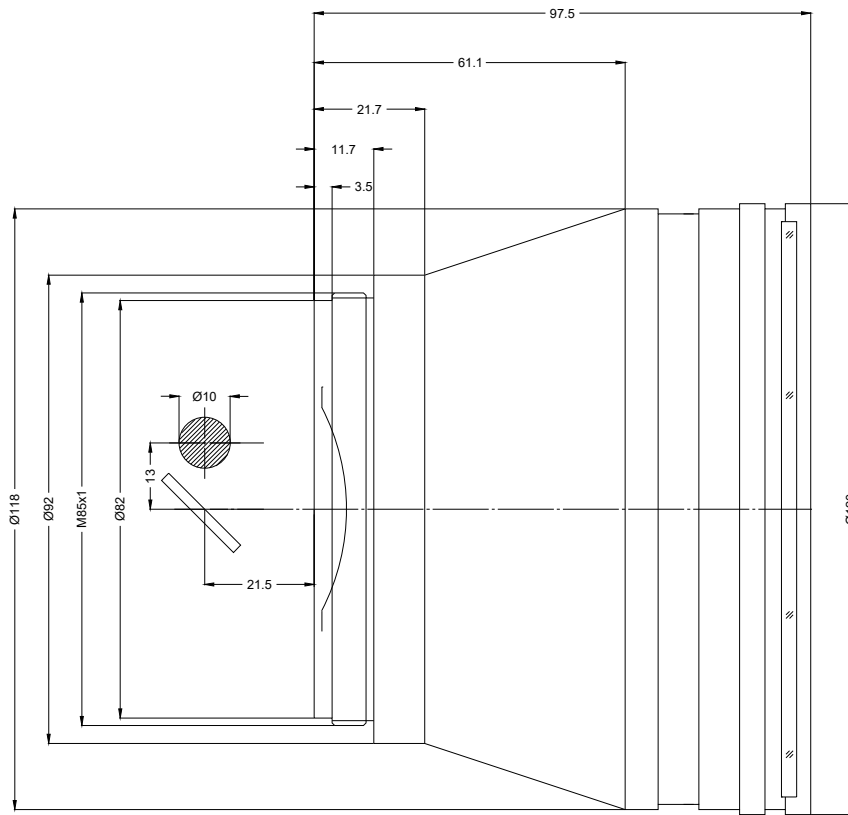

F-Theta lens

f-120T-10-510-550

Dimensions are given in millimeters and are intended as reference values.
Binding information is available on request.

