

F - T H E T A L E N S

f-167T-14-510-550

en | Data sheet | 1.1

- Telecentric fused silica lens
- Wavelength 510 – 550 nm
- Nominal focal length 167 mm
- Max. input beam diameter 14 mm
- Maximum working area 86 x 86 mm



Wavelength	510 – 550 nm	Mirror distance m1/m2	17 / 22.3 – 27.8 mm
Nominal focal length	167 mm	Anti-reflective coating	Standard
Effective focal length	166.512 mm	Telecentric error	3 °
Flange focal length	331.233 mm	Cooling method	Air
Max. input beam diameter	14 mm	Lens material	Fused silica
Working distance	233.233 mm	Mounting thread	M85x1
Max. scan field	86 x 86 mm	Lens diameter	140 mm
Minimum spot size	11.61 µm		

Information is subject to change without notice.
Product photos are non-binding and may show customized features.



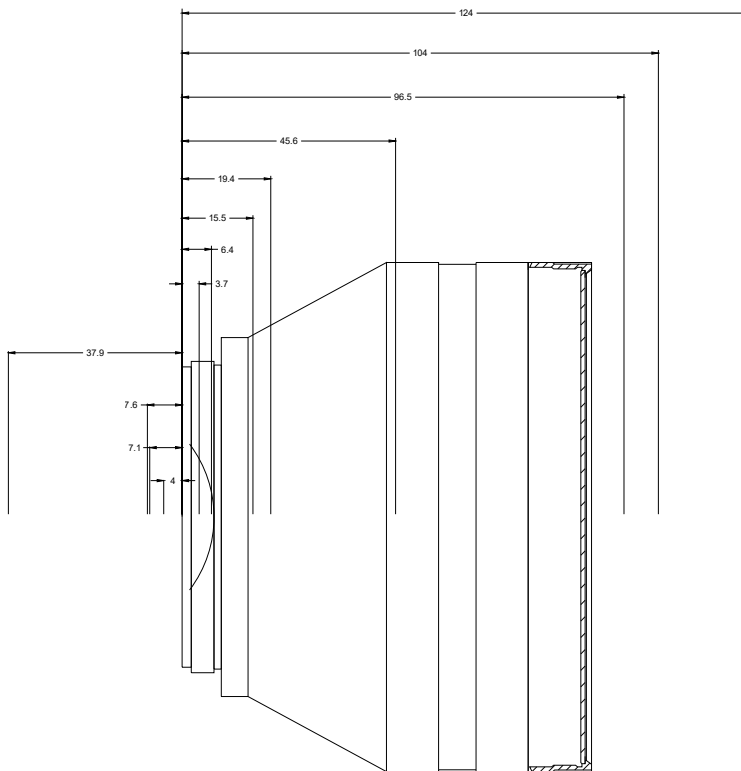
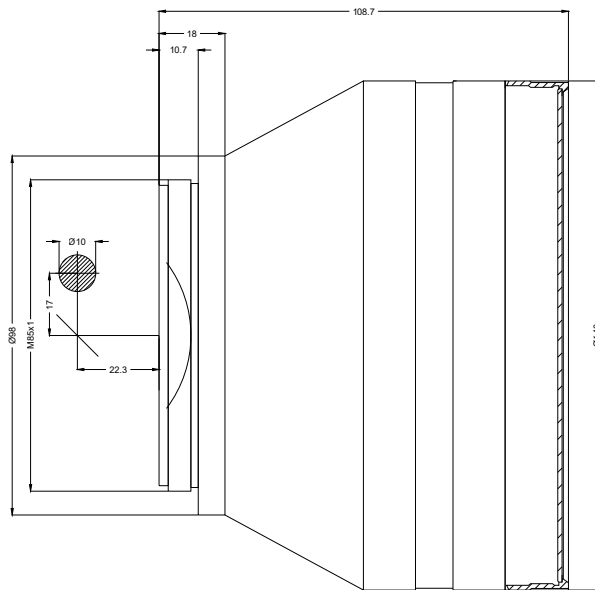

F-Theta lens

f-167T-14-510-550

Dimensions are given in millimeters and are intended as reference values.
Binding information is available on request.

