

F - T H E T A L E N S

f-150T-20-9.3

en | Data sheet | 1.0

- Telecentric F-Theta Lens, 9300 nm, ZnSe
- Nominal focal length 150 mm
- Maximum input aperture 20 mm
- Maximum working area 90 x 90 mm
- Fine focus, high power density



Wavelength	9300 nm	Mirror distance m1/m2	25.6 / 18.6 mm
Nominal focal length	150 mm	Anti-reflective coating	Standard
Effective focal length	150.000 mm	Telecentric error	5.9 °
Flange focal length	252.500 mm	Cooling method	Air
Max. input beam diameter	20 mm	Lens material	ZnSe
Working distance	169.000 mm	Mounting thread	M85x1
Max. scan field	90 x 90 mm	Lens diameter	154 mm
Minimum spot size	120.2 µm		

Information is subject to change without notice.
Product photos are non-binding and may show customized features.



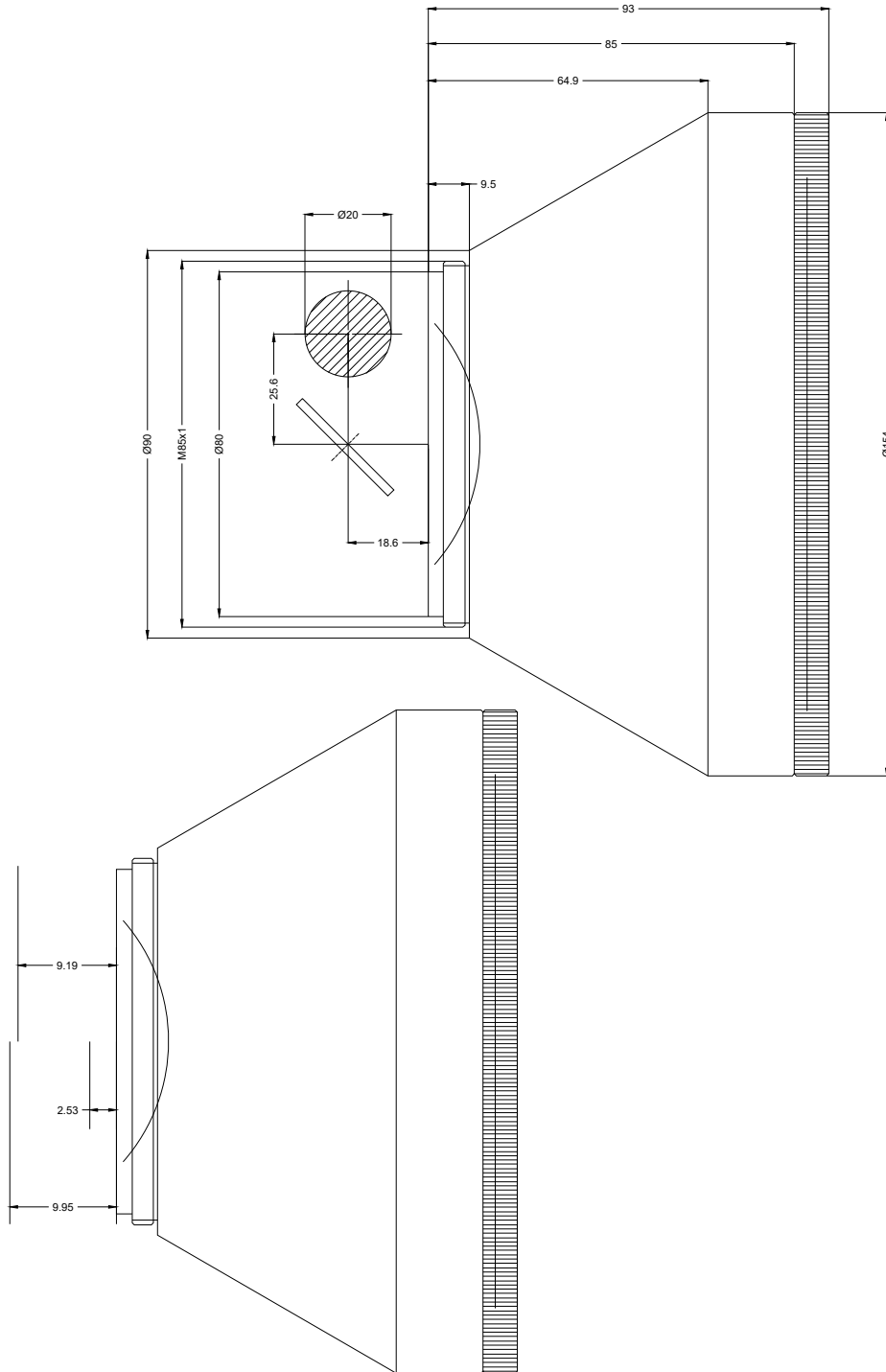

F-Theta lens

f-150T-20-9.3

Dimensions are given in millimeters and are intended as reference values.
Binding information is available on request.

