

F - T H E T A L E N S

f-210T-14-980

en | Data sheet | 1.1

- Telecentric F-Theta Lens, 980 nm
- Nominal focal length 210 mm
- Max. input beam diameter 14 mm
- Maximum working area 100 x 100 mm



Wavelength	980 nm	Mirror distance m1/m2	17 / 25 – 36 mm
Nominal focal length	210 mm	Anti-reflective coating	Standard
Effective focal length	210.000 mm	Telecentric error	4 °
Flange focal length	373.260 mm	Cooling method	Air
Max. input beam diameter	14 mm	Lens material	Optical glass
Working distance	275.655 mm	Mounting thread	M85x1
Max. scan field	100 x 100 mm	Lens diameter	134 mm
Minimum spot size	26.9 µm		

Information is subject to change without notice.
Product photos are non-binding and may show customized features.



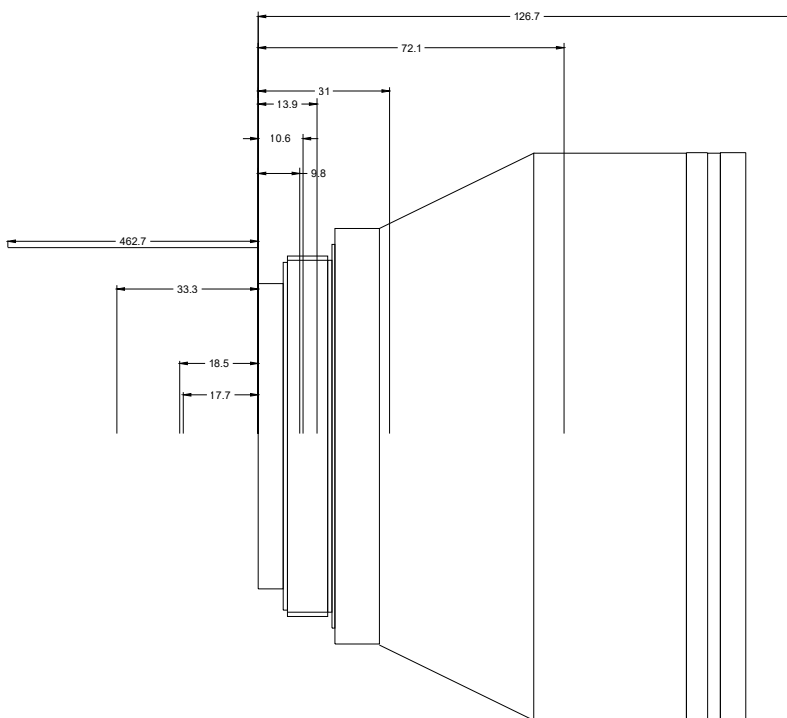
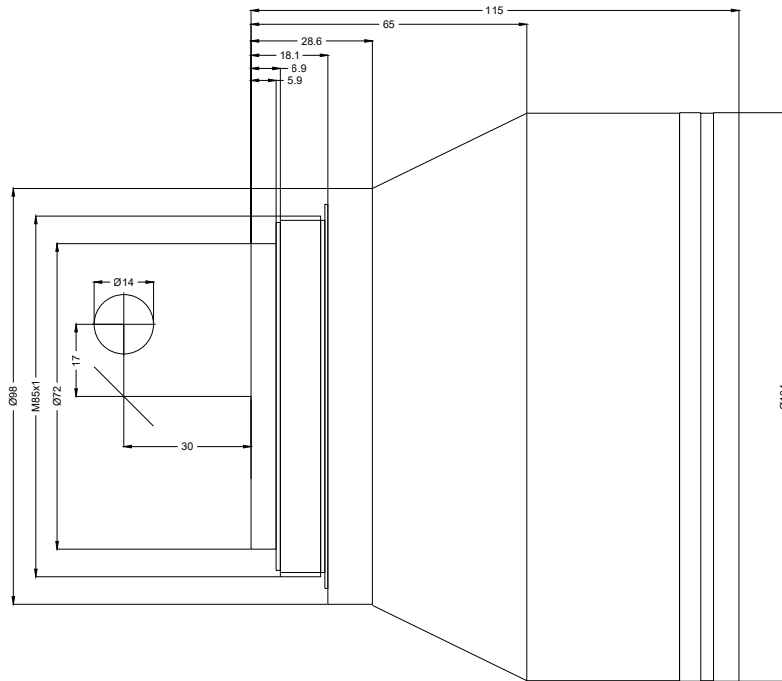

F-Theta lens

f-210T-14-980

Dimensions are given in millimeters and are intended as reference values.
Binding information is available on request.

