

F - T H E T A L E N S

f-255-14-1030-1080-W

en | Data sheet | 1.0

- Fused silica lens, 1030 – 1080 nm
- Nominal focal length 255 mm
- Max. input beam diameter 14 mm
- Maximum working area 175 x 175 mm
- Water-cooled, high power compatibility



Wavelength	1030 – 1080 nm	Minimum spot size	18.05 µm
Nominal focal length	255 mm	Mirror distance m1/m2	17 / 19 mm
Effective focal length	255.000 mm	Anti-reflective coating	Standard
Flange focal length	399.000 mm	Cooling method	Water
Max. input beam diameter	14 mm	Lens material	Fused silica
Working distance	321.000 mm	Mounting thread	M85x1
Max. scan field	175 x 175 mm	Lens diameter	166 mm

Information is subject to change without notice.
Product photos are non-binding and may show customized features.



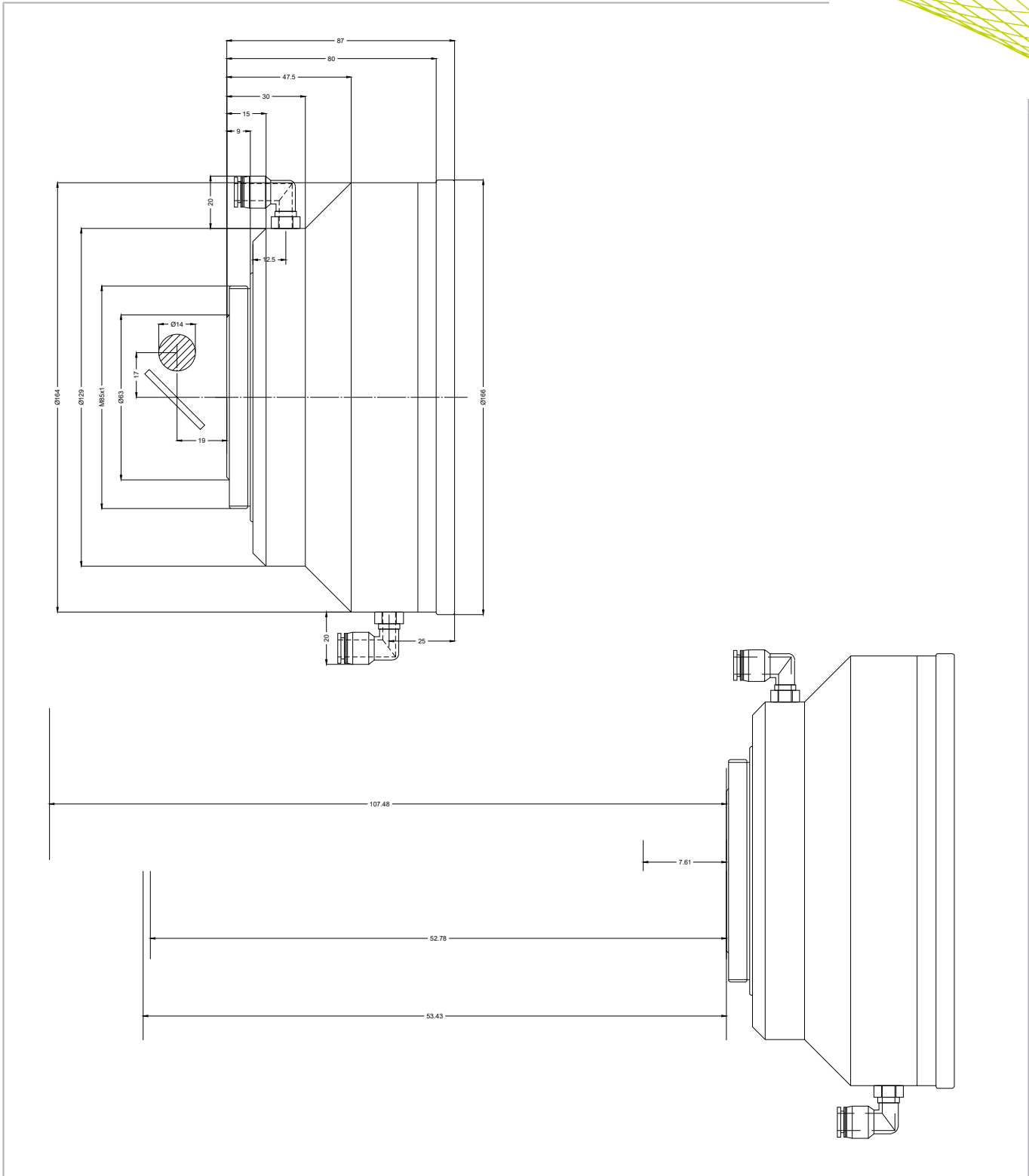

	F-Theta lens
	f-255-14-1030-1080-W

Dimensions are given in millimeters and are intended as reference values. Binding information is available on request.