

F - T H E T A L E N S

f-170-30-1064-M112X1

en | Data sheet | 1.0

- F-Theta Focusing Lens, 1064 nm
- Nominal focal length 170 mm
- Max. input beam diameter 30 mm
- Maximum working area 80 x 80 mm
- Very fine focus, high precision



Wavelength	1064 nm	Minimum spot size	11.03 μ m
Nominal focal length	170 mm	Mirror distance m1/m2	37.12 / 23 mm
Effective focal length	169.923 mm	Anti-reflective coating	Standard
Flange focal length	262.742 mm	Cooling method	Air
Max. input beam diameter	30 mm	Lens material	Optical glass
Working distance	197.242 mm	Mounting thread	M112x1
Max. scan field	80 x 80 mm	Lens diameter	140 mm

Information is subject to change without notice.
Product photos are non-binding and may show customized features.



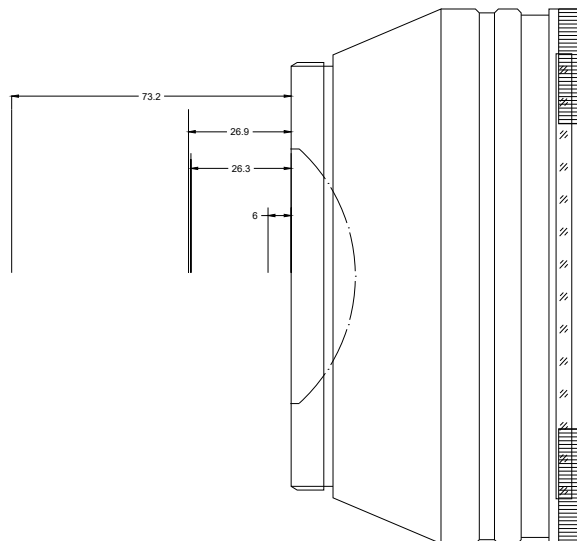
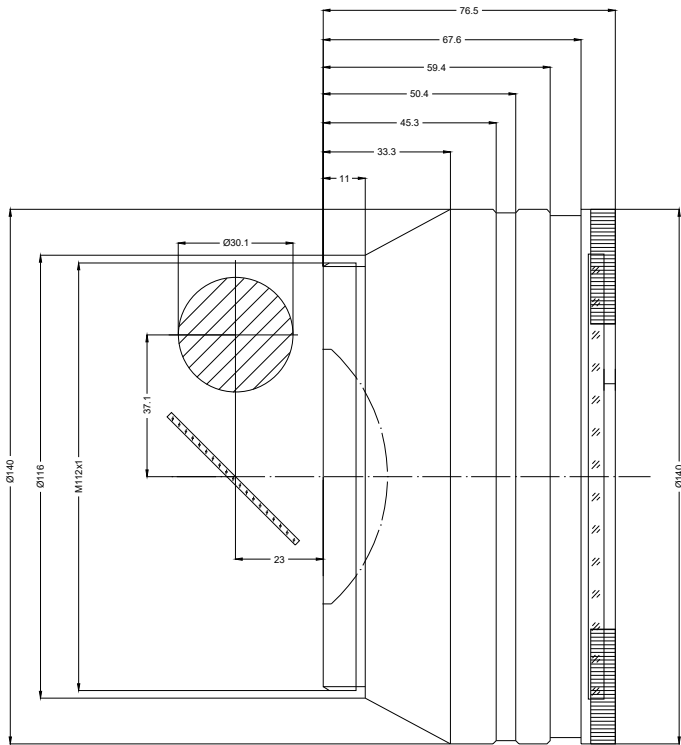

F-Theta lens

f-170-30-1064-M112X1

Dimensions are given in millimeters and are intended as reference values.
Binding information is available on request.

