

F - T H E T A L E N S

f-210G-10-1064

en | Data sheet | 1.1

- F-Theta Focusing Lens, 1064 nm
- Nominal focal length 210 mm
- Max. input beam diameter 10 mm
- Maximum working area 150 x 150 mm



Wavelength	1064 nm	Minimum spot size	40.9 μm
Nominal focal length	210 mm	Mirror distance m1/m2	12.5 / 15 mm
Effective focal length	209.554 mm	Anti-reflective coating	Standard
Flange focal length	240.378 mm	Cooling method	Air
Max. input beam diameter	10 mm	Lens material	Optical glass
Working distance	231.878 mm	Mounting thread	M85x1
Max. scan field	150 x 150 mm	Lens diameter	90 mm

Information is subject to change without notice.
Product photos are non-binding and may show customized features.



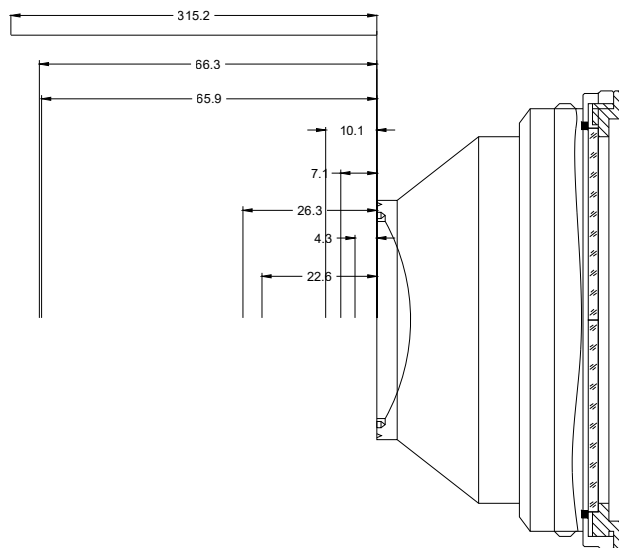
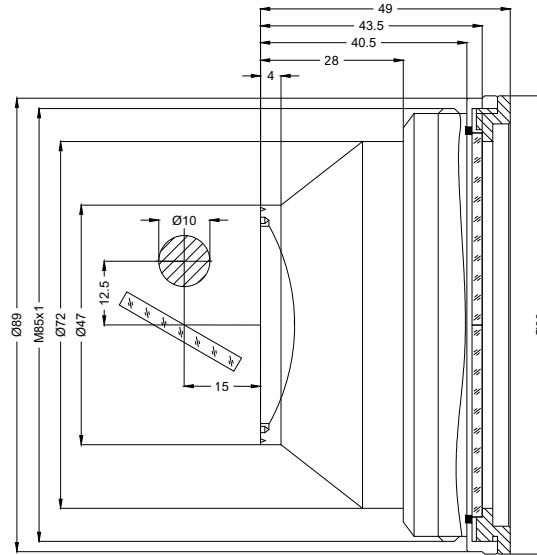

F-Theta lens

f-210G-10-1064

Dimensions are given in millimeters and are intended as reference values.
Binding information is available on request.

