

F - T H E T A L E N S

# f-420-14-355-W

en | Data sheet | 1.0

- Fused Silica F-Theta Lens, 355 nm
- Nominal focal length 420 mm
- Max. input beam diameter 14 mm
- Maximum working area 250 x 250 mm
- Water-cooled, high power compatibility



Wavelength	355 nm	Minimum spot size	9.94 μm
Nominal focal length	420 mm	Mirror distance m1/m2	17 / 21.5 mm
Effective focal length	420.000 mm	Anti-reflective coating	Standard
Flange focal length	589.300 mm	Cooling method	Water
Max. input beam diameter	14 mm	Lens material	Fused silica
Working distance	526.700 mm	Mounting thread	M85x1
Max. scan field	250 x 250 mm	Lens diameter	135 mm

Information is subject to change without notice.  
Product photos are non-binding and may show customized features.



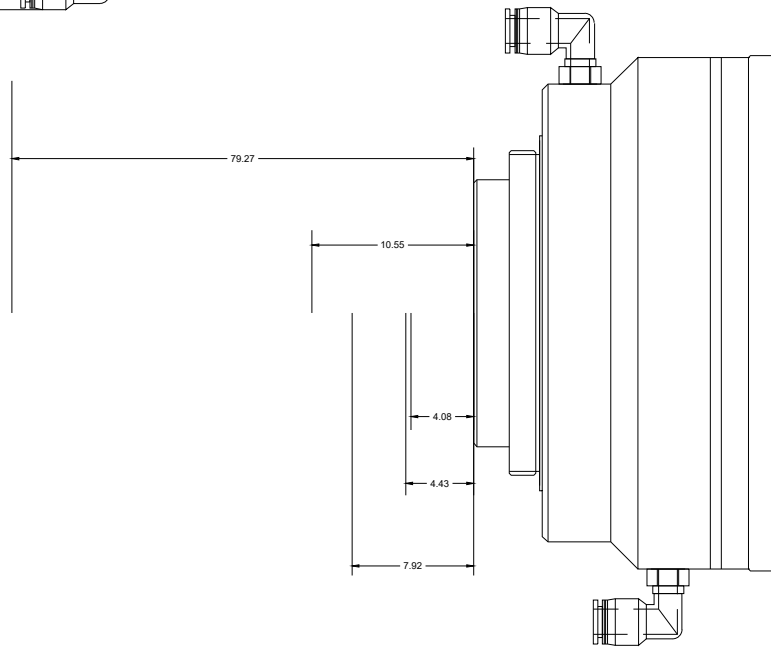
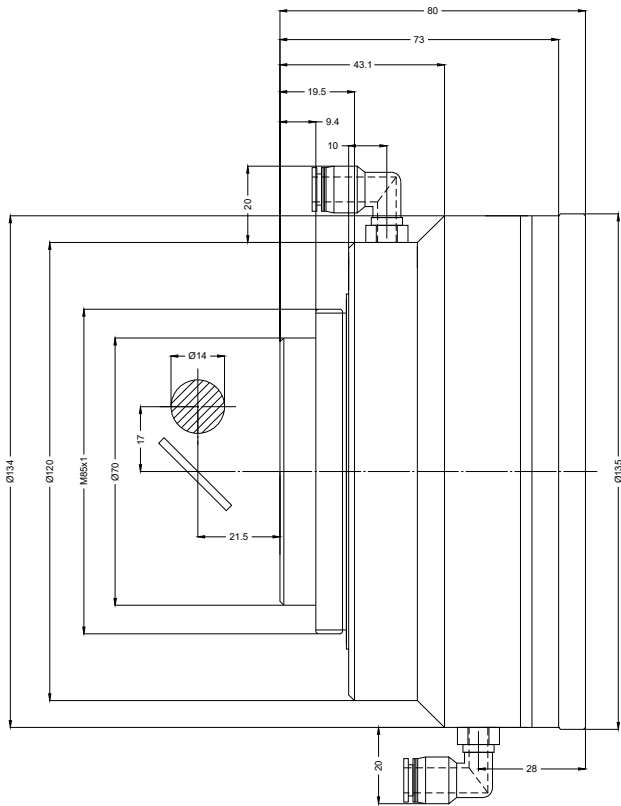

F-Theta lens

f-420-14-355-W

Dimensions are given in millimeters and are intended as reference values.  
Binding information is available on request.

