

F - T H E T A L E N S

# f-500-14-405

en | Data sheet | 1.0

- Fused Silica F-Theta Lens, 405 nm
- Nominal focal length 500 mm
- Max. input beam diameter 14 mm
- Maximum working area 350 x 350 mm



Wavelength	405 nm	Minimum spot size	26.45 µm
Nominal focal length	500 mm	Mirror distance m1/m2	17 / 19.75 mm
Effective focal length	499.725 mm	Anti-reflective coating	Standard
Flange focal length	605.840 mm	Cooling method	Air
Max. input beam diameter	14 mm	Lens material	Fused silica
Working distance	567.840 mm	Mounting thread	M85x1
Max. scan field	350 x 350 mm	Lens diameter	105 mm

Information is subject to change without notice.  
Product photos are non-binding and may show customized features.



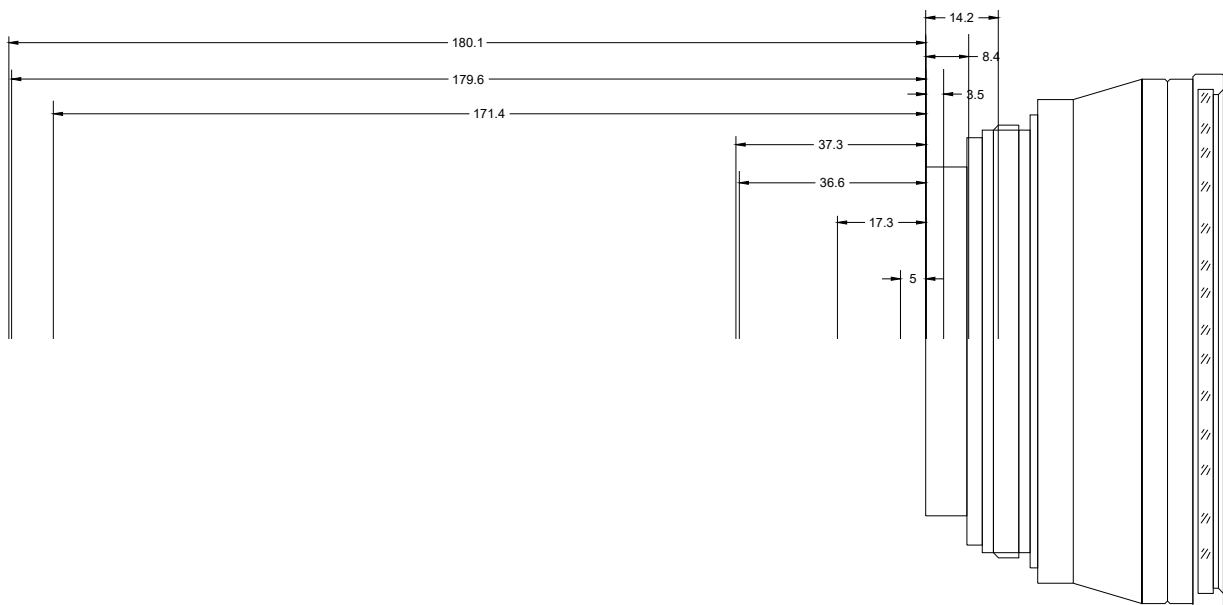
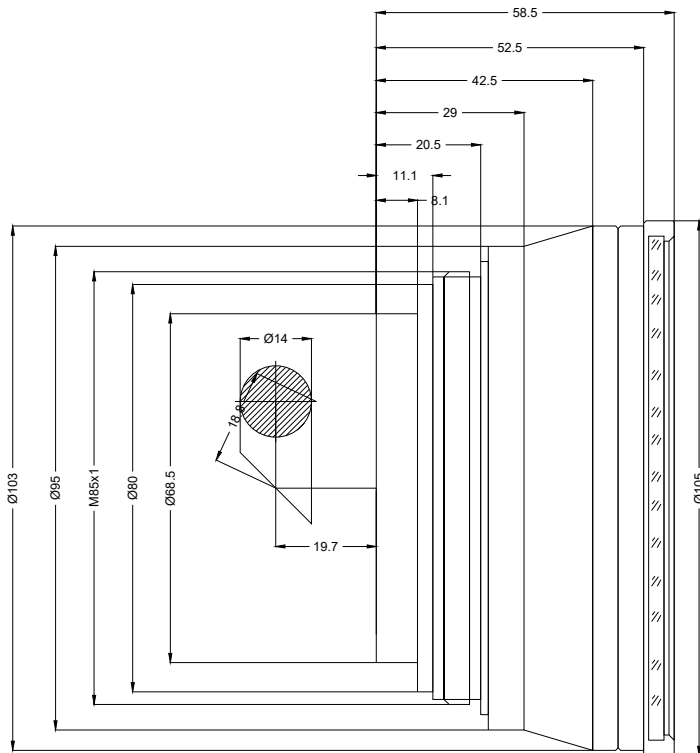

F-Theta lens

f-500-14-405

Dimensions are given in millimeters and are intended as reference values.  
Binding information is available on request.

