

F - T H E T A L E N S

f-245-20-510-550

en | Data sheet | 1.0

- Fused Silica F-Theta Lens, 510 – 550 nm
- Nominal focal length 245 mm
- Max. input beam diameter 20 mm
- Maximum working area 123 x 123 mm



Wavelength	510 – 550 nm	Minimum spot size	12.17 μ m
Nominal focal length	245 mm	Mirror distance m1/m2	25.9 / 19.4 mm
Effective focal length	245.000 mm	Anti-reflective coating	Standard
Flange focal length	367.569 mm	Cooling method	Air
Max. input beam diameter	20 mm	Lens material	Fused silica
Working distance	310.169 mm	Mounting thread	M85x1
Max. scan field	123 x 123 mm	Lens diameter	120 mm

Information is subject to change without notice.
Product photos are non-binding and may show customized features.



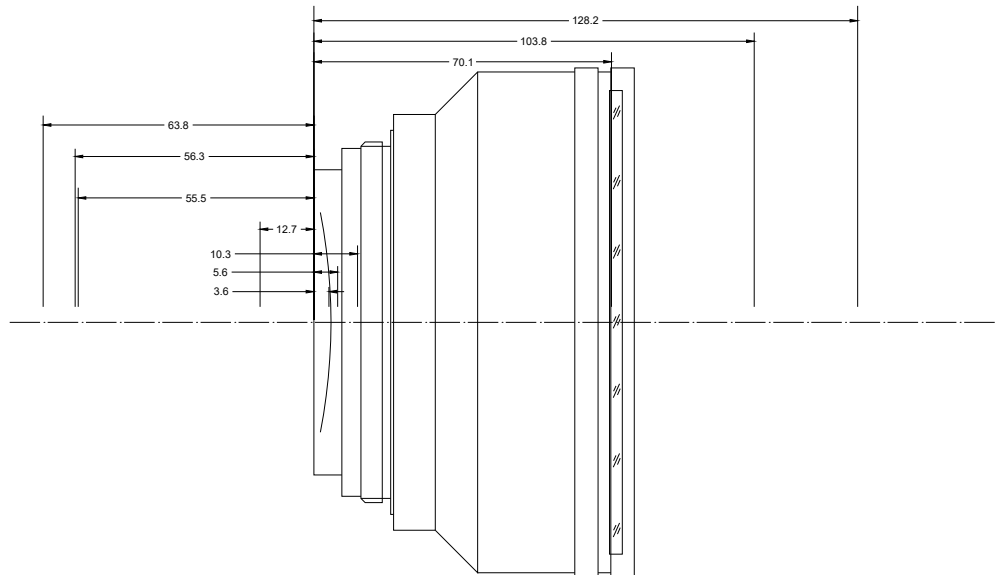
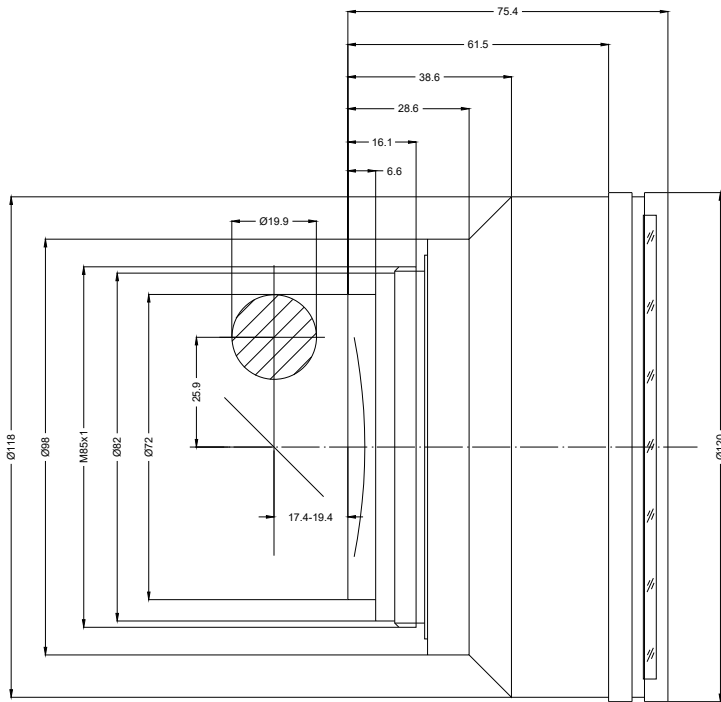

F-Theta lens

f-245-20-510-550

Dimensions are given in millimeters and are intended as reference values.
Binding information is available on request.

