

F - T H E T A L E N S

f-255-14-510-550

en | Data sheet | 1.1

- Fused Silica F-Theta Lens, 510 – 550 nm
- Nominal focal length 255 mm
- Max. input beam diameter 14 mm
- Maximum working area 160 x 160 mm
- Fine focus, high power density



Wavelength	510 – 550 nm	Minimum spot size	17.73 μ m
Nominal focal length	255 mm	Mirror distance m1/m2	17 / 19.51 mm
Effective focal length	254.990 mm	Anti-reflective coating	Standard
Flange focal length	318.313 mm	Cooling method	Air
Max. input beam diameter	14 mm	Lens material	Fused silica
Working distance	367.813 mm	Mounting thread	M85x1
Max. scan field	160 x 160 mm	Lens diameter	120 mm

Information is subject to change without notice.
Product photos are non-binding and may show customized features.



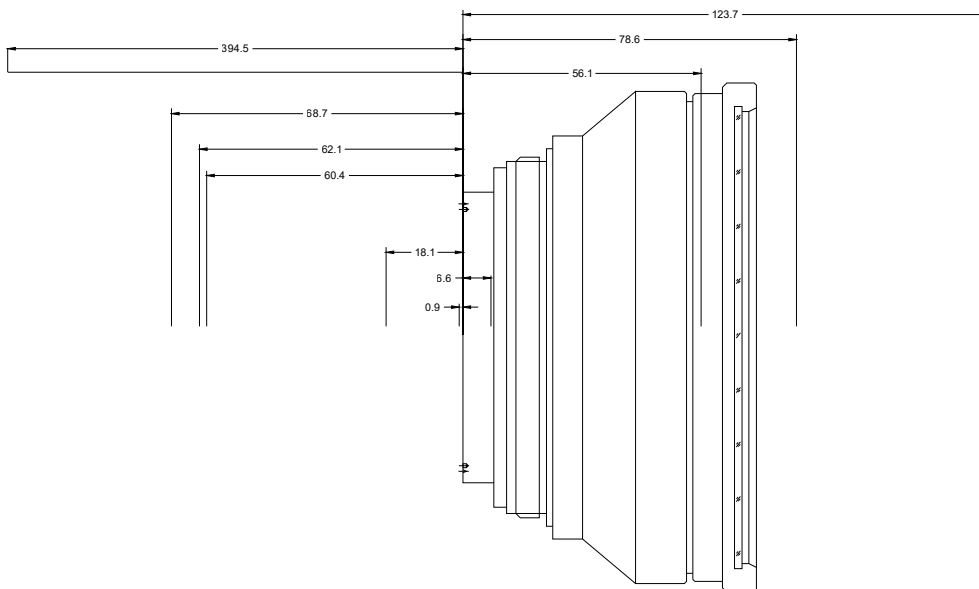
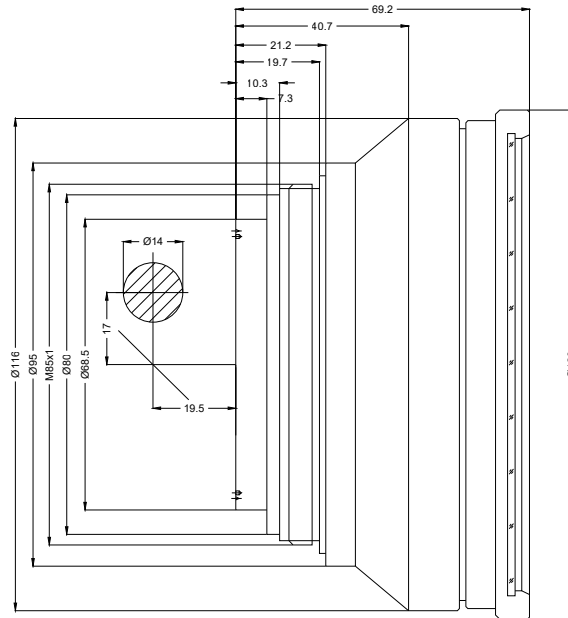

F-Theta lens

f-255-14-510-550

Dimensions are given in millimeters and are intended as reference values.
Binding information is available on request.

