

F - T H E T A L E N S

f-410-14-532

en | Data sheet | 1.1

- F-Theta Focusing Lens, 532 nm
- Nominal focal length 410 mm
- Max. input beam diameter 14 mm
- Maximum working area 280 x 280 mm



Wavelength	532 nm	Minimum spot size	28.51 μ m
Nominal focal length	410 mm	Mirror distance m1/m2	29.5 / 16 mm
Effective focal length	410.000 mm	Anti-reflective coating	Standard
Flange focal length	522.100 mm	Cooling method	Air
Max. input beam diameter	14 mm	Lens material	Optical glass
Working distance	474.000 mm	Mounting thread	M85x1
Max. scan field	280 x 280 mm	Lens diameter	120 mm

Information is subject to change without notice.
Product photos are non-binding and may show customized features.



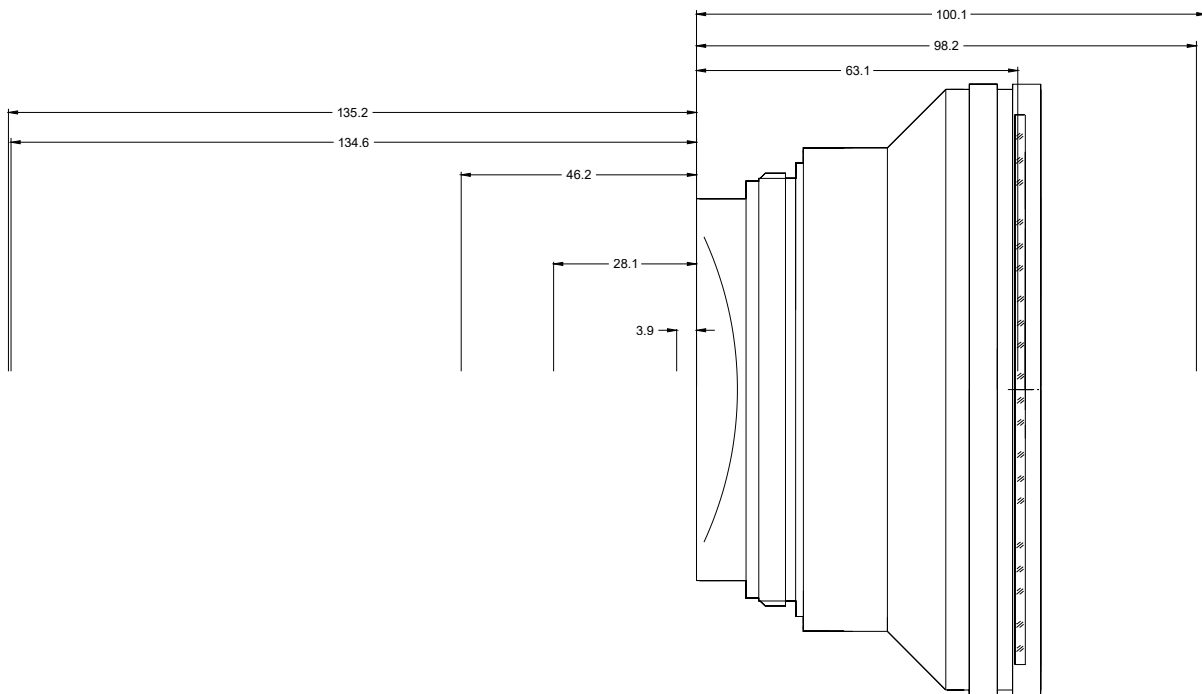
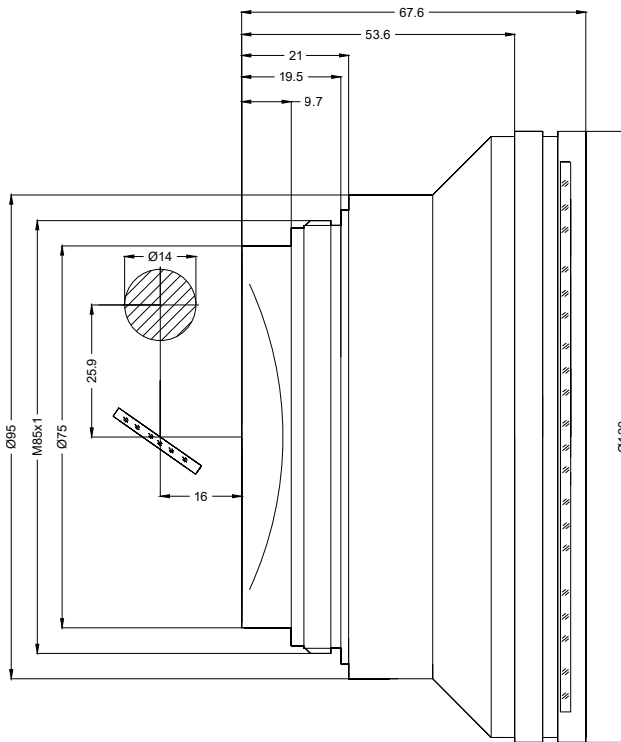

F-Theta lens

f-410-14-532

Dimensions are given in millimeters and are intended as reference values.
Binding information is available on request.

