

F - T H E T A L E N S

f-420-14-915-980

en | Data sheet | 1.1

- Fused Silica F-Theta Lens, 915 – 980 nm
- Nominal focal length 420 mm
- Max. input beam diameter 14 mm
- Maximum working area 300 x 300 mm



Wavelength	915 – 980 nm	Minimum spot size	53.8 µm
Nominal focal length	420 mm	Mirror distance m1/m2	17 / 19.8 mm
Effective focal length	420.126 mm	Anti-reflective coating	Standard
Flange focal length	543.329 mm	Cooling method	Air
Max. input beam diameter	14 mm	Lens material	Fused silica
Working distance	496.829 mm	Mounting thread	M85x1
Max. scan field	300 x 300 mm	Lens diameter	122 mm

Information is subject to change without notice.
Product photos are non-binding and may show customized features.



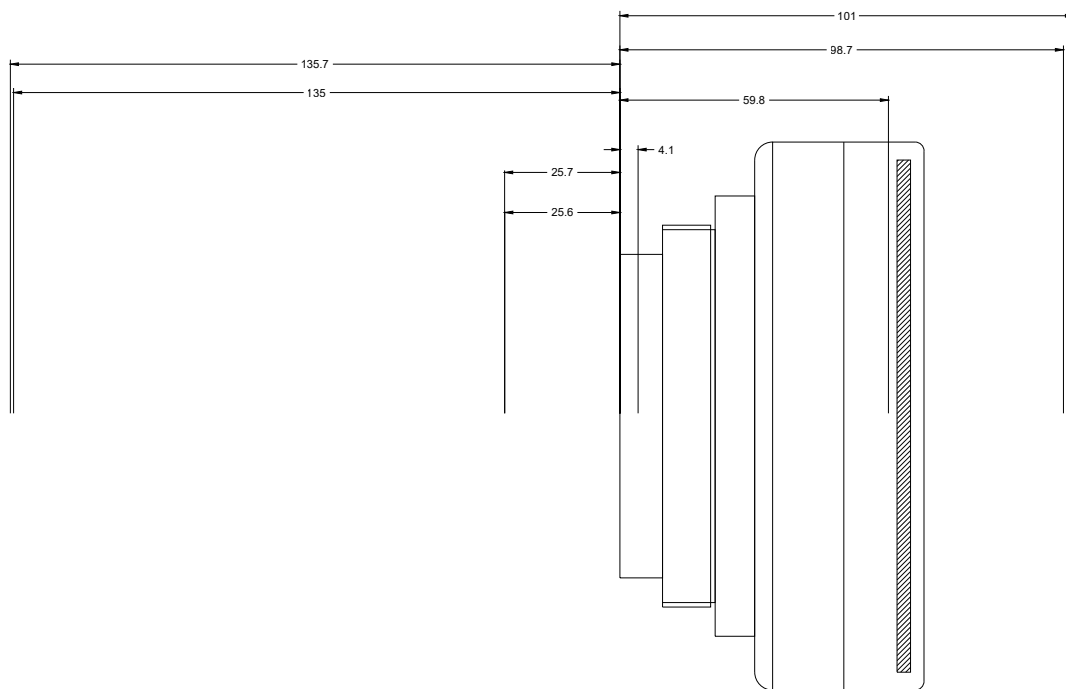
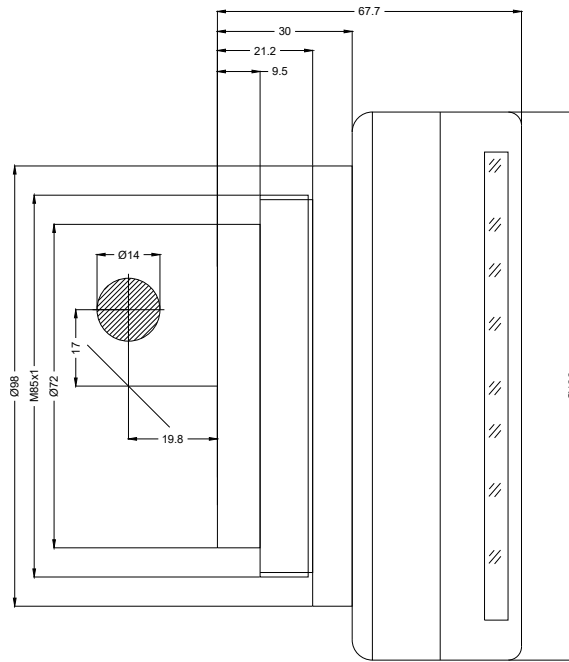

F-Theta lens

f-420-14-915-980

Dimensions are given in millimeters and are intended as reference values.
Binding information is available on request.

