

F - T H E T A L E N S

f-220-14-9.3

en | Data sheet | 1.0

- F-Theta Lens 9300 nm, ZnSe
- Nominal focal length 220 mm
- Max. input beam diameter 14 mm
- Maximum working area 140 x 140 mm



Wavelength	9300 nm	Minimum spot size	267.4 μ m
Nominal focal length	220 mm	Mirror distance m1/m2	17 / 20.27 mm
Effective focal length	223.121 mm	Anti-reflective coating	Standard
Flange focal length	256.294 mm	Cooling method	Air
Max. input beam diameter	14 mm	Lens material	ZnSe
Working distance	242.294 mm	Mounting thread	M85x1
Max. scan field	140 x 140 mm	Lens diameter	90 mm

Information is subject to change without notice.
Product photos are non-binding and may show customized features.



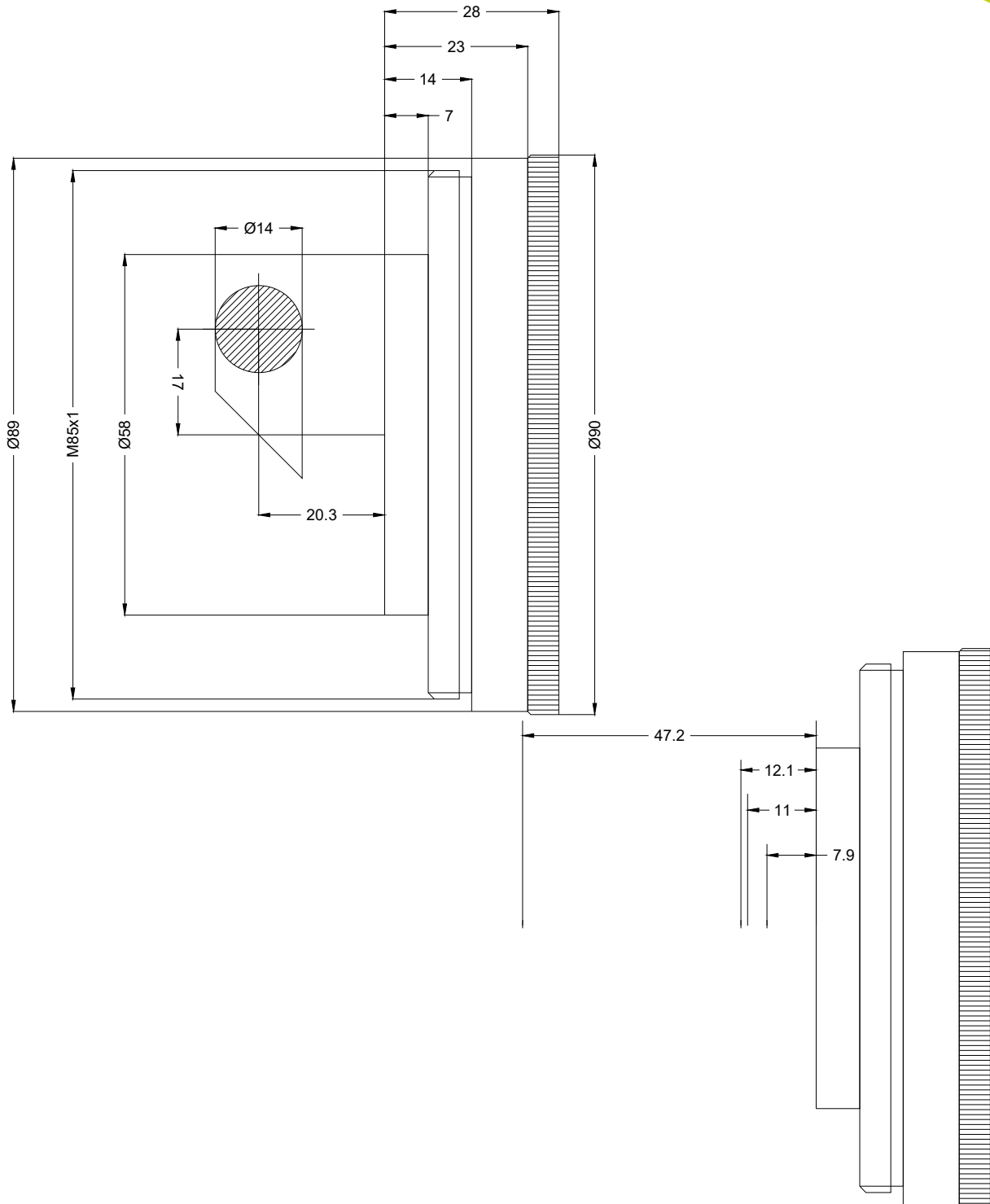

F-Theta lens

f-220-14-9.3

Dimensions are given in millimeters and are intended as reference values.
Binding information is available on request.

