

F - T H E T A L E N S

f-380-20-940-980

en | Data sheet | 1.0

- F-Theta Lens, 940 – 980 nm
- Nominal focal length 380 mm
- Max. input beam diameter 20 mm
- Maximum working area 235 x 235 mm



Wavelength	940 – 980 nm	Minimum spot size	34.1 µm
Nominal focal length	380 mm	Mirror distance m1/m2	25.12 / 25 mm
Effective focal length	390.121 mm	Anti-reflective coating	Standard
Flange focal length	515.067 mm	Cooling method	Air
Max. input beam diameter	20 mm	Lens material	Optical glass
Working distance	473.667 mm	Mounting thread	M85x1
Max. scan field	235 x 235 mm	Lens diameter	120 mm

Information is subject to change without notice.
Product photos are non-binding and may show customized features.



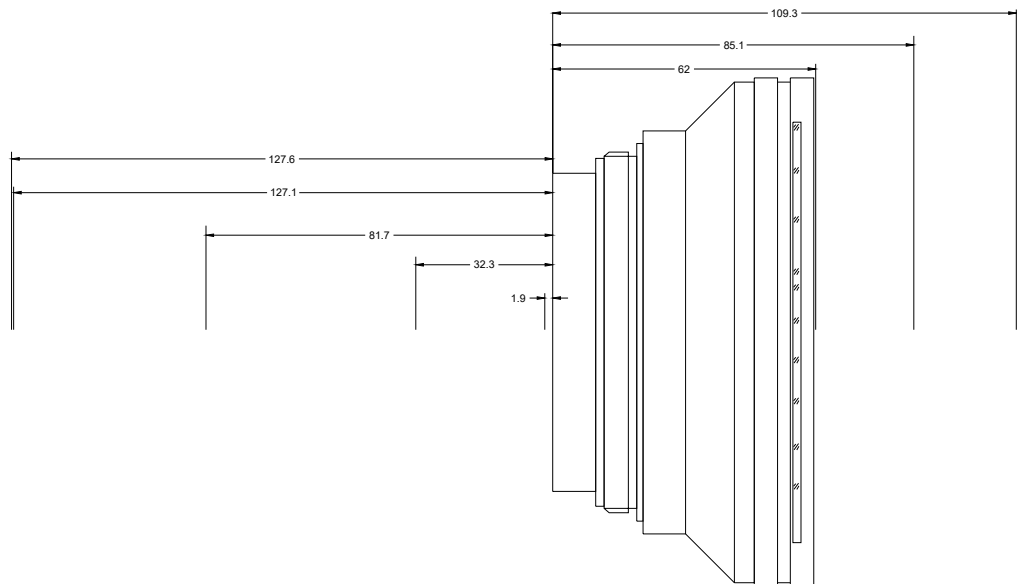
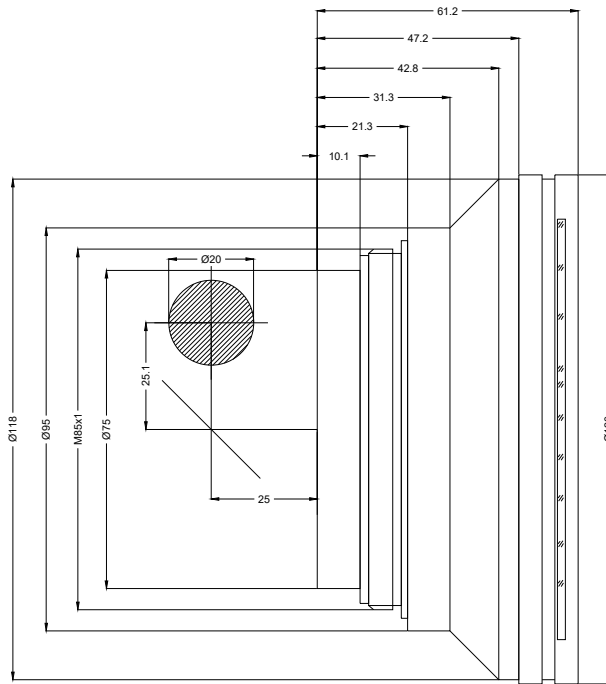

F-Theta lens

f-380-20-940-980

Dimensions are given in millimeters and are intended as reference values.
Binding information is available on request.

