

2 D SCAN HEAD

BS-8

en | Data sheet | 1.2

- 2-axis laser deflection unit, aperture 8 mm
- High speed and precision
- Compact temperature-optimized design
- Outstanding cost-effectiveness



Wavelength	1064 nm ^[1]	Long-term-drift per axis (8 h)	300 µrad
Input beam diameter	8 mm	Cooling method	Passive
Tracking delay	0.12 ms	Control interface	XY2-100-Standard
Writing speed	900 cps	Humidity	80% ^[2]
Max. optical deflection	0.39 rad	Supply voltage DC	15 V
Resolution	12 µrad	Current consumption	3 A
Repeatability (RMS)	22 µrad	Operation temperature	10 – 40 °C
Positioning noise (RMS)	4.5 µrad	Storage temperature	-20 – 60 °C
Max. gain-drift per axis	50 ppm/K	Mechanical dimensions (W × D × H)	89 × 109 × 92 mm
Max. offset-drift per axis	30 µrad/K	Net weight	1.2 kg

^[1] Other available wavelengths: 355 / 532 / 10600 nm

^[2] Non condensing



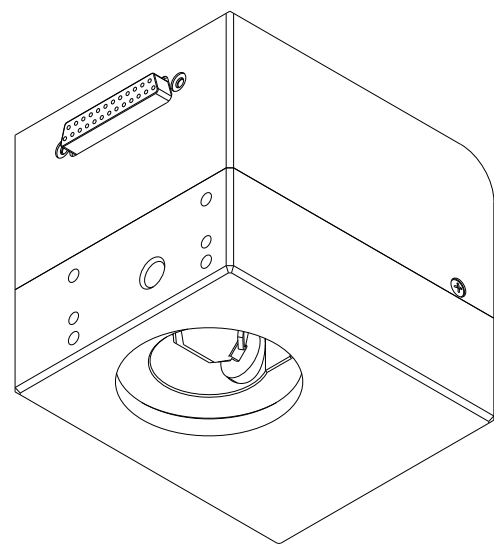
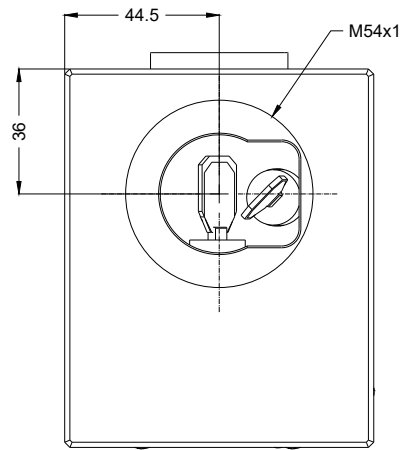
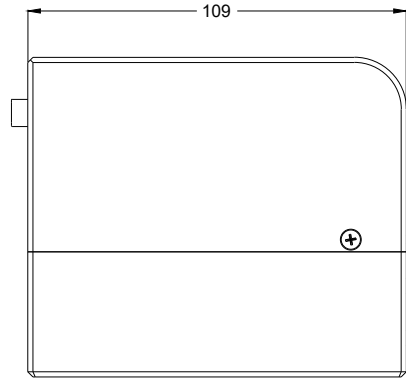
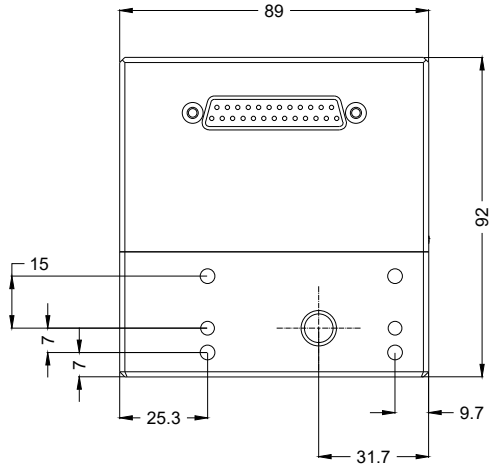

2D scan head

BS-8

Dimensions are given in millimeters and are intended as reference values.
Binding information is available on request.

