

2 D SCAN HEAD

# PSH-20-H-W

en | Data sheet | 1.1.1

- Premium 2-axis laser scan head / 20 mm
- Highest precision with minimal drift
- Laser powers up to 2000 Watt, CW 1064 nm
- Designed for demanding laser applications



Wavelength	1030 – 1080 nm
Input beam diameter	20 mm
Tracking delay	0.28 ms
Writing speed	400 cps
Marking speed	2 m/s
Max. optical deflection	0.35 rad
Resolution	12 µrad
Repeatability (RMS)	2 µrad
Positioning noise (RMS)	2 mrad
Max. gain-drift per axis	20 ppm/K
Max. offset-drift per axis	20 µrad/k

Long-term-drift per axis (8 h)	80 µrad
Cooling method	Water
Cooling power	3 l/min
Control interface	XY2-100-Standard
Humidity	80% <sup>[1]</sup>
Supply voltage DC	15 V
Current consumption	5 A
Operation temperature	15 – 35 °C
Storage temperature	-35 – 60 °C
Mechanical dimensions (W × D × H)	134 × 195 × 155 mm
Net weight	6 kg

<sup>[1]</sup> Non condensing



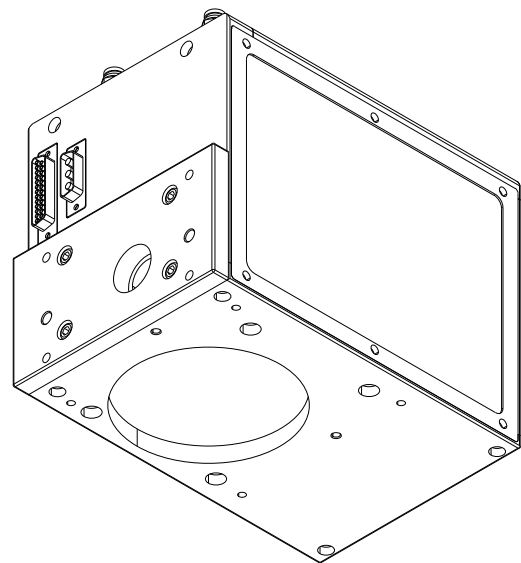
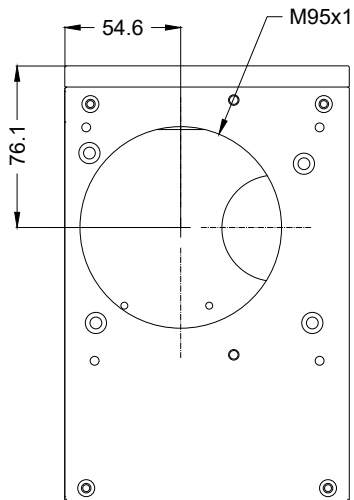
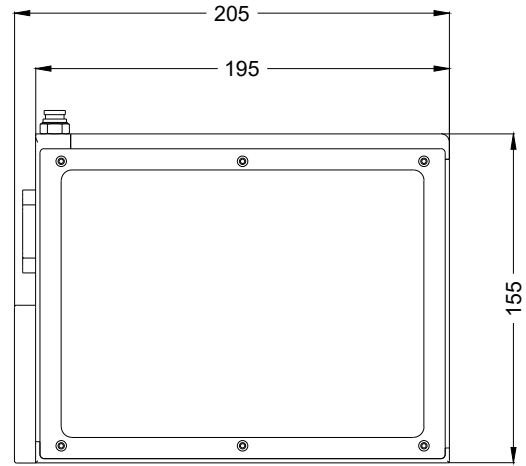
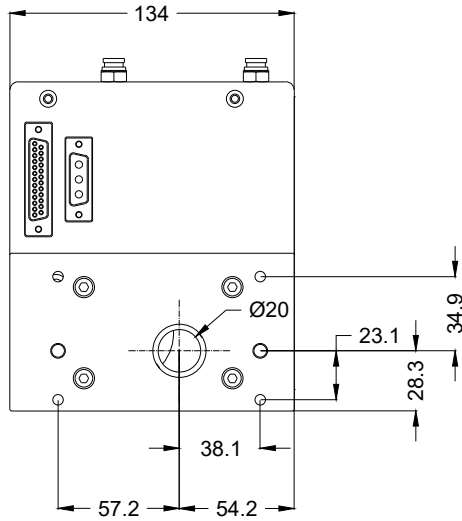

2D scan head

PSH-20-H-W

Dimensions are given in millimeters and are intended as reference values.  
Binding information is available on request.

