

2 D SCAN HEAD

PSH-20

en | Data sheet | 1.1

- Premium 2-axis laser scan head / 20 mm
- Highest precision with minimal drift
- Laser power up to 1000 Watt, CW 1064 nm
- Designed for demanding laser applications



Wavelength	1030 – 1080 nm ^[1]	Long-term-drift per axis (8 h)	50 µrad
Input beam diameter	20 mm	Cooling method	Passive
Tracking delay	0.28 ms	Control interface	XY2-100-Standard
Writing speed	450 cps	Humidity	80% ^[2]
Max. optical deflection	0.418 rad	Supply voltage DC	15 V
Resolution	12 µrad	Current consumption	5 A
Repeatability (RMS)	2 µrad	Operation temperature	15 – 35 °C
Positioning noise (RMS)	2 µrad	Storage temperature	-10 – 60 °C
Max. gain-drift per axis	15 ppm/K	Mechanical dimensions (W × D × H)	120 × 176 × 131 mm
Max. offset-drift per axis	10 µrad/K	Net weight	5.3 kg

^[1] Other available wavelengths: 10600 nm

^[2] Non condensing



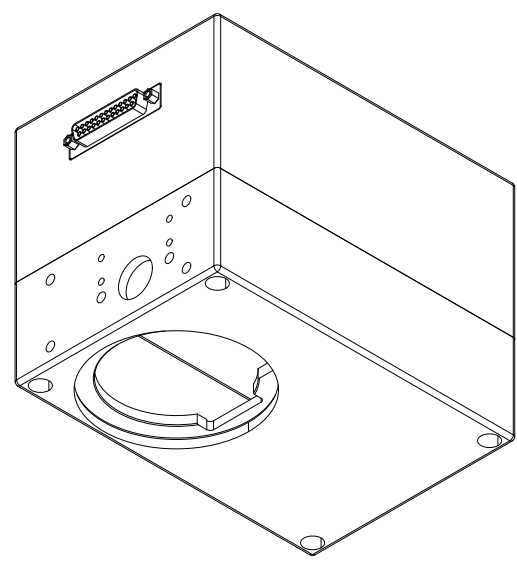
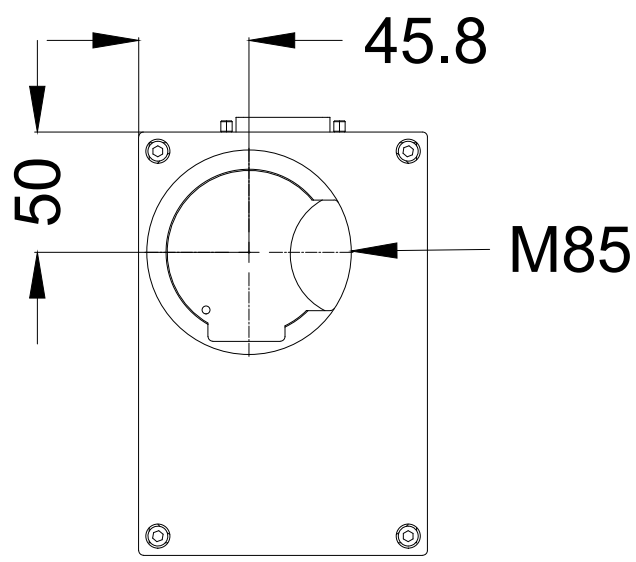
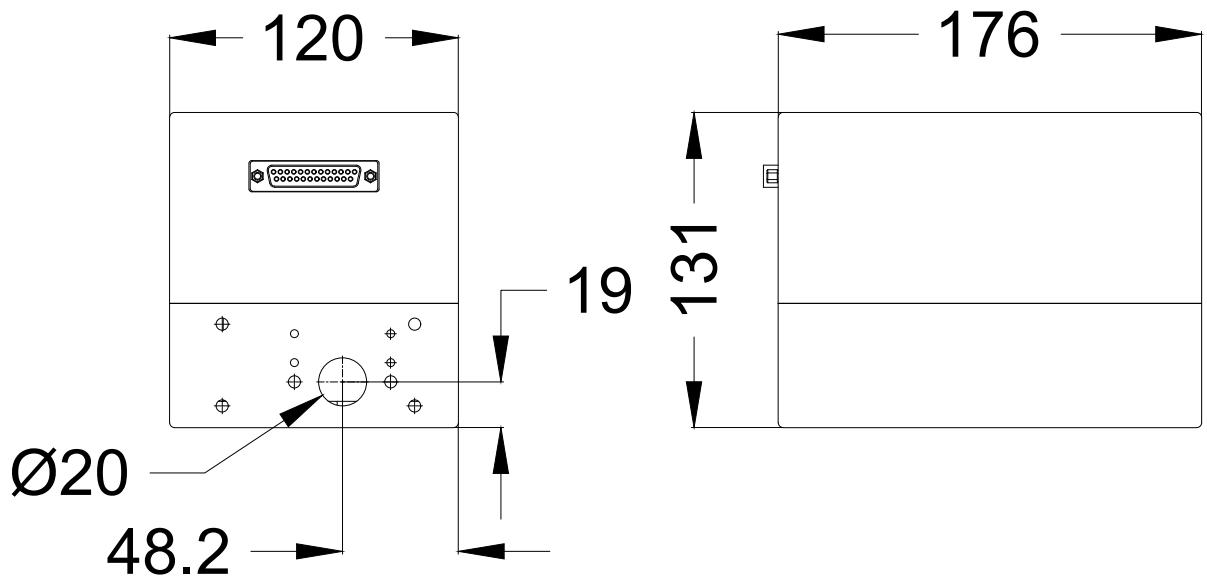

		2D scan head
		PSH-20

Dimensions are given in millimeters and are intended as reference values.
Binding information is available on request.

