

2 D SCAN HEAD

PSH-30-A-W

en | Data sheet | 1.0

- Premium 2-axis laser scan head / 30 mm
- Superior precision and minimum drift
- Designed for demanding laser applications with laser power up to 1000 Watt (IR, CW)
- For battery foil cutting, microstructuring and additive manufacturing

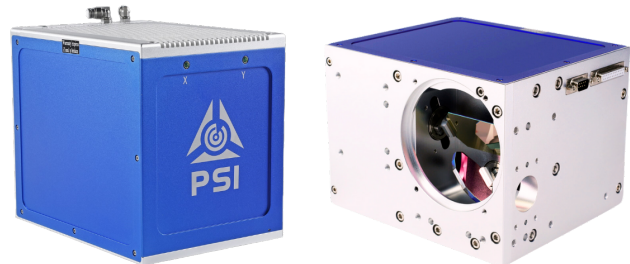

Wavelength	1064 nm	Long-term-drift per axis (8 h) (<)	50 µrad
Input beam diameter	30 mm	Cooling method	Water
Max. laser power @ 1064 nm CW (<)	1000 W	Cooling flowrate	3 l/min
Tracking delay	0.36 ms	Control interface	XY2-100
Writing speed	300 cps ^[1]	Humidity	80 % ^[2]
Positioning speed (<)	10 m/s	Supply voltage DC	15 V
Marking speed	1,5 m/s	Current consumption	10 A
Max. optical deflection (±)	0.35 rad	Operation temperature	15 – 35 °C
Resolution	12 µrad	Storage temperature	-35 – 60 °C
Repeatability (RMS) (<)	2 µrad	Mechanical dimensions (W × D × H)	152 × 206.9 × 180 mm
Max. gain-drift per axis	15 ppm/K	Net weight	6.9 kg
Max. offset-drift per axis	15 µrad/K		

^[1] f=160 / Hight 1 mm

^[2] Non condensing



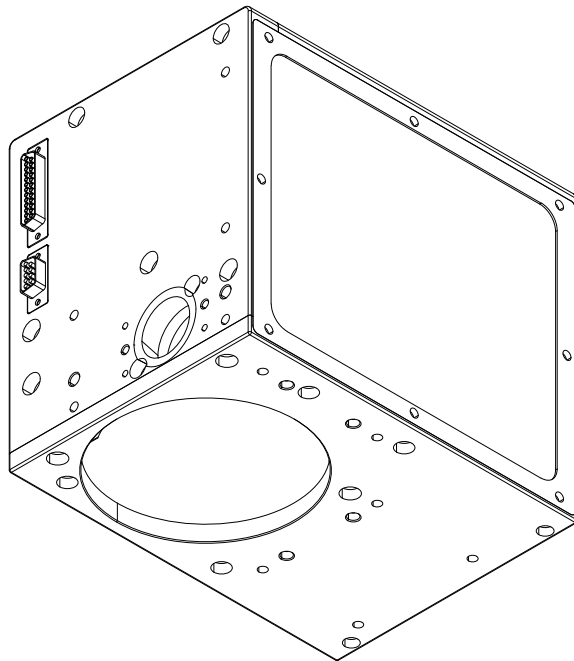
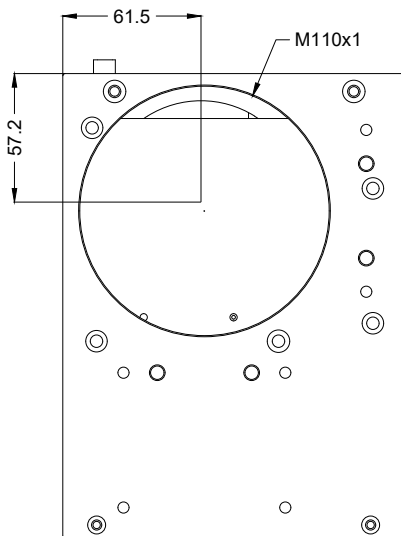
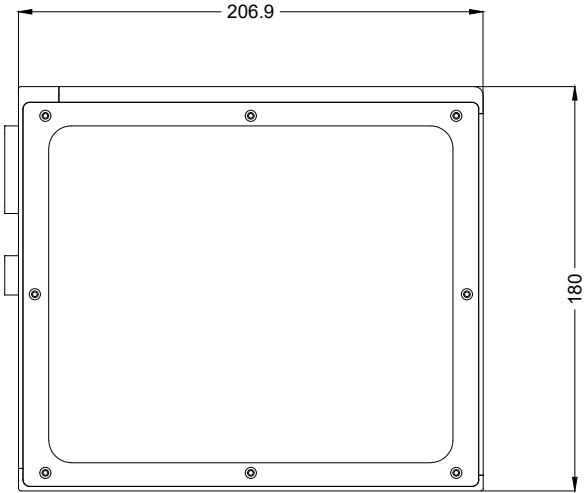
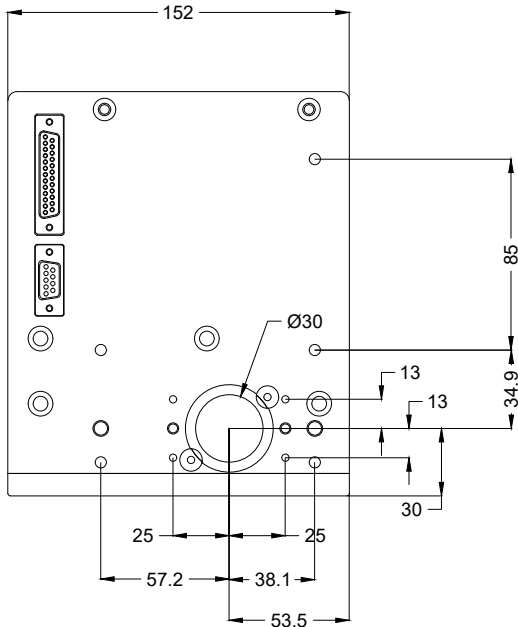

2D scan head

PSH-30-A-W

Dimensions are given in millimeters and are intended as reference values.
Binding information is available on request.

